

Infrastructure Urbanity

BY JAMES ENOS, SENIOR

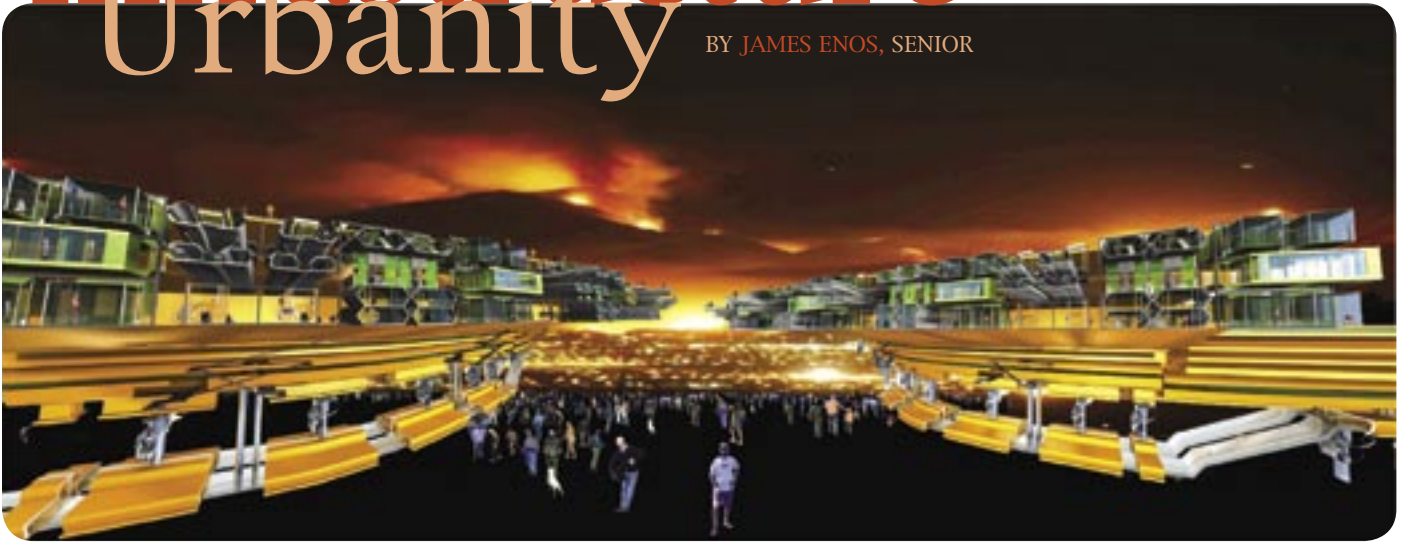

PROJECT DEVELOPED UNDER THE GUIDANCE OF TEDDY CRUZ,
LEN ZEGARSKI, CAMERON CROCKETT, AND ALAN ROSENBLUM

This project proposes a human scaled diaphragm intended for multiple authorship and the continual adaptation of habitat. It is a Petri dish for a social re-direction; out of our historic faults and manipulated privatization schemes and into a communally restructuring process that takes advantage of our market dependence, e.g. increased efficiency driving cost/production structures to slim attainable minimums. This is achieved by locating and further isolating critical points (dynamic geographies of abundance) of capital activity for use. Moreover, by formalizing our colonization within exchange mediums we increase our ability to weather class depreciation from continual restructuring processes of comparative advantage and industrial selection.

Transnational capital continually patrols physical infrastructure systems and provides abundant resource for an unharnessed and sensible urbanism. This project advocates the need for another massive intervention at the scale of the New Deal in 1958 that futuristically led to the development of major public works, such as our interstate system and the modern circulatory freeway. This inquiry supposes that an exhaustive analysis of global commodity flow and dependence can further benefit an architecturally conscious spatialization. Critical points of interchange are to be marked as strategic typologies for the promotion of density.

It is intended to combat the viral sprawl that the fist wave of connective projects had created in-between our watersheds, and to promote slimming the super-organism. The project requires the insertion of a multiple author open-source system serving as a diaphragm for the future of privatization and collectivity. It is a layering of ourselves upon the market which resides upon our communicative/transit system. It is measured to maximize efficiency, distribute abundance, and gift our lives more time (less spent in the pursuit of elusive capital).

As offers of architecture, we are to provide solutions that will weather the continual restructuring processes of accumulation as they occur. We are to provide an architecture of time and connection to grow past the superficialities of capital.



Interoperability and Dependence: Evolving Complexity

The importance of tight connections is easily seen under the super organism construction. Our economy's reliance on the expansion of technological and social systems demands a greater interweaving for the future. The process of global integration and extended market dependence creates an environment of fused reliability. For example, if General Electric seeds to expand their market penetration in Yemen to develop a new consumer base, they begin to forge a future dependant capitalistic relationship of the aforementioned production - consumption nature. This transcends all former boundaries and plants the seed for future communicative contact. Further integration will promote homogenization, yet it will continue to increase individual freedom for the pursuit of objects. However, in the short term it can be seen that there will be a by-product of diversity, yet eventually this will be eradicated for new-formed global norms. Eventual

uniformity can still yield diversity but it is a fact that diversity reigns under the prospect of variance. Continual variance must be built into the system as a series of chaotic mis-encounters or actions that breed deference. In respect to the architecture of a super system, we must set forth highly compoundable and adaptive building blocks that are sturdy and simple in their inception. For any internal or imaginary future configuration to take place, we need structures that are incomplete and stay evolvable in constant disequilibria.

There is great promise that this super organism will continue to combine and collide our little worlds without recourse unless we learn how to guide it through the act of architectural spatialization. The information revolution is clearly a communicative paradigm shift that has created a planetary nervous system. Moreover, the advent of distributed processing

amongst de-centralized machines has created a super intelligent super being with the capability to trump anything before. However, these developments are strictly linked to the will of capital appreciation. What we will have to begin questioning is which end-user ideology these acts serve. Technology alone will not save us from directive of transnational development and only an intelligent embrace of transition can begin to guide our influence upon the quality of capital space. This high-powered super-computing-organism continues to proliferate and is beginning to resemble its own controlling agent or global brain. This is part of an evolutionary transition to a higher level of complexity. The remaining question is whether this transition will lead to the integration of the whole of humanity [collective], producing a human "super-being" or merely enhance the capabilities of the share-holding few [individuals], thus producing a multitude of "meta-beings".

SR14 INTERCHANGE COLONY [SECTIONS]

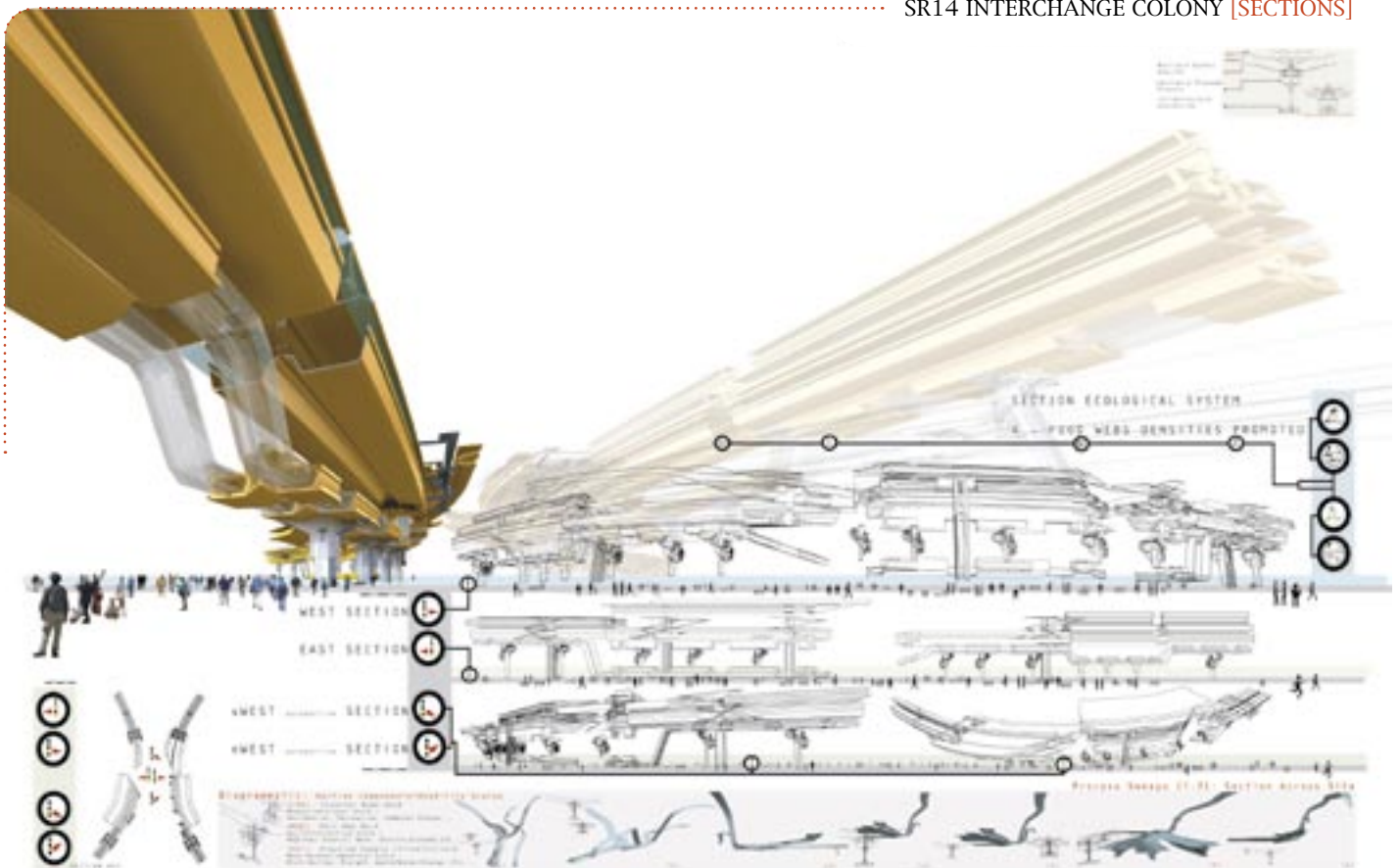

INDIVIDUALS OF SCALE: COLLECTIVE/1

A solitary ant in a field cannot be considered to have much of anything on his mind; indeed, with only a few neurons strung together by fibers, he can't be imagined to have a mind at all, much less a thought. He is more like a ganglion on legs. Four ants together, or ten,

encircling a dead moth on a path, begin to look more like an idea. They fumble and shove gradually moving the food toward the hill but, as though by blind chance, it is only when you watch the dense mass of thousands of ants, crowded together around the hill, blackening

the ground, that you begin to see the whole beast, and now you observe it thinking, planning, calculating. It is an intelligence, a kind of live computer, with crawling bits for its wits.

ADDITIONAL RACK MASSING UPON INFRASTRUCTURE



Dual Hub Converge
Main Hub Docks
From Ground Plane

Dual Hub Total
HHD Feeding System
+ Total Decks

Skewed Perspective
From Base Center
Looking N/West

Deck Internal
Unit Elevation Vista

Perspective Collision
2 HHD Vista



Capital Spaces/Productive Dwelling [1-8]: Relax/Expand/Scour Opportunities



Nomadic Plug/Dependant Class [1-8]: Hang On/Search Scraps/Manage Disabilities



Single Professional Transitions/Climbing Class [1-8]: Ladder Housing Mobile Lifestyle/Vertical Aspirations

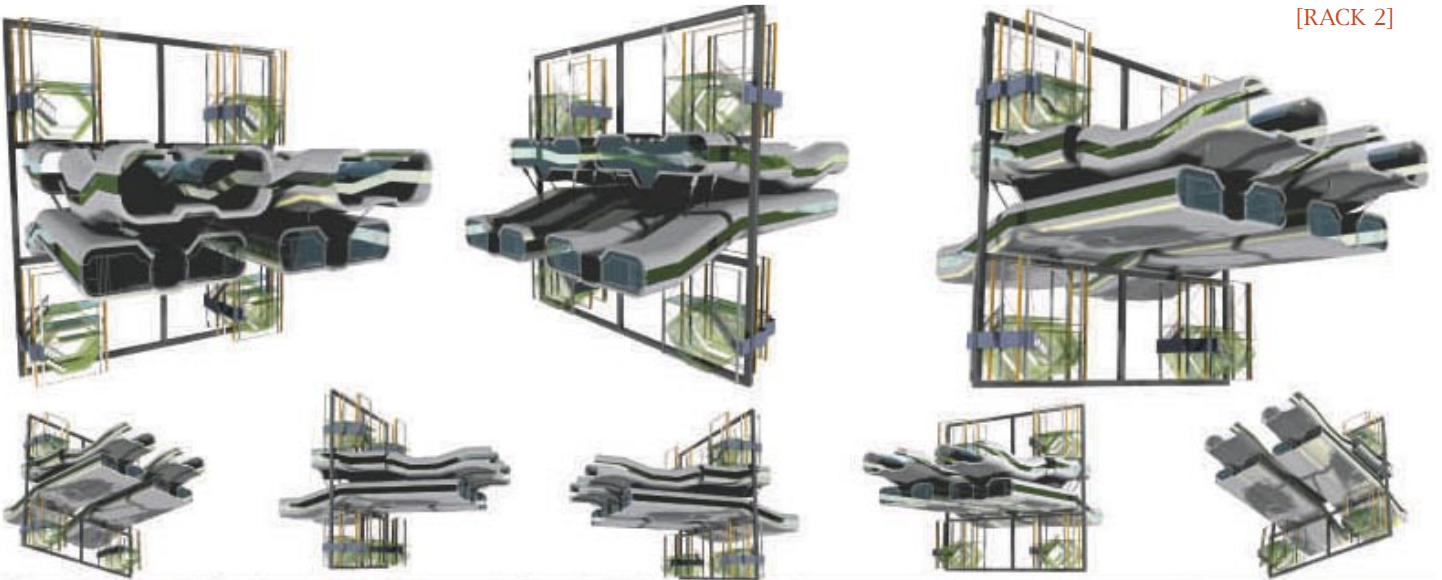

[RACK 2]

Capitalist Pads with Visual Exploitation Pods

HUB MARKET CYCLE: RELATIONSHIPS/VARY



CHASE YOURSELF: GUIDE WHAT YOU GROW

This project intends to strategize upon the idea that we can somehow manipulate the accumulative processes of transnational capital in order to reap social benefit. This means that if we begin to study the major points of exchange, collection, or abundance, we can plan our alterations accordingly. If the world is rapidly hybridizing, polarizing, or homogenizing under definite and eventual onslaught of globalization, how do we begin to respond with principals that can serve as adaptive urbanizing methods? How can we respond to new typologies such as habitable transit interchange, such as I am suggesting? It is my thesis that suggests we will need to seek out these interchanges for the abundance they offer and the urbanity they will vitally support. It is a matter of when not if.

Look at the fastest growing cities, economies, and regions; what we find is a positive correlation between the proximity to infrastructure and the magnitude of transnational capital resource (junctions of colony). What I have tried to examine is the need for another massive intervention at the scale of the New Deal in 1958 that futuristically led to the development of major public works such as our interstate system, and the modern circulatory freeway that bisects our city/lives. What I am proposing in light of predictions for greater polarity amongst the class structures of our world, is a social infrastructure/public works agenda to begin to curve the viral sprawl that the first wave

Parasite Renters Aspiring to become Owners

of connective projects has created in between our watersheds. I am looking for the insertion of a multiple author open-source system serving as a diaphragm for the future of privatization and the social public. It is a layering of the market upon our communicative/transit system as an attempt to maximize efficiency, distribute abundance, and curb regional ills associated with capital's certain restructure.

The location of a critical interchange exists. In fact, there are many points where all is present to increase the efficiency of the social urban machine. It is the charge of architecture to spatialize our needs and effectively manage individual requests from the greater machine. This intervention is made most compoundable at the infrastructure level.

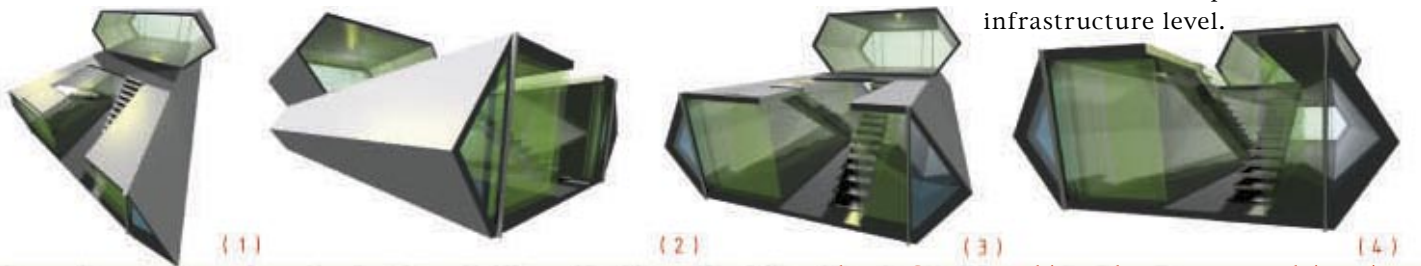

Plug in Commercial/Mixed Use Units: Work/Live/Rent

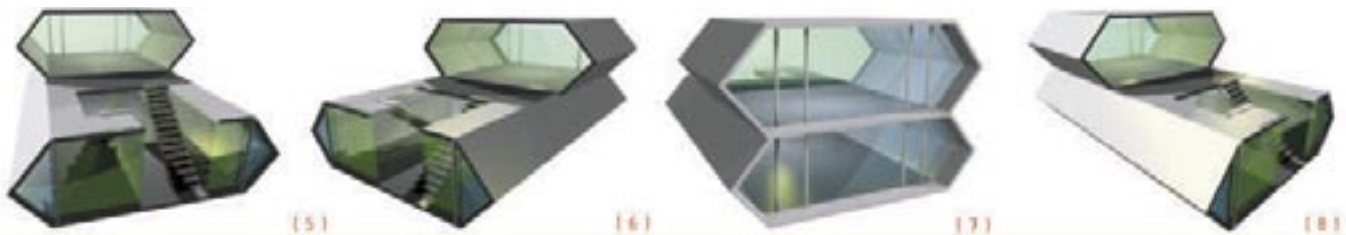

EMERGING GEOGRAPHIES: IT WILL GROW

A human scaled diaphragm interred for multiple authorship and the continual adaptation of habitat. This is a Petri dish for a social redirection; out of our historic faults and manipulated privati-

zation schemes and into a communally restructuring process that takes advantage of our market dependence, e.g. increased efficiency driving cost/production structures to slim attainable

minimums. By locating and further isolating critical points (dynamic geographies) of capital activity, we increase our ability to resist class depreciation due to the continual restructuring of comparative advantage by industry.

ADDITIONAL RACK MASSING UPON INFRASTRUCTURE



Ground Impact North/West Perspective
Main Hub Desk Unit Attachments

Level Elevation South/West
Rack Vistas From Mirroring Deck

Warm's Eye
From Base Center

30x60 Total Sweep
Unit Population on Central Level

Projection of Verticality
Unit Ascertainment Vertically